

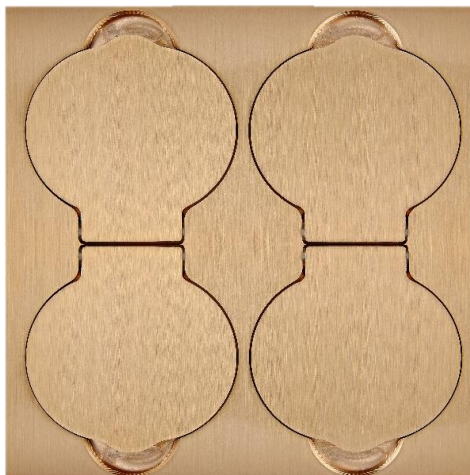

D



Q



S

1 GENERAL INFORMATION

- **Material:** Brass 11mm
- **Weight:** 400g **S** / 800g **D** / 1500g **Q**
- **Spacing between screws:** 60mm
- **Fixing:** Screws
- **Fitting:** 10 minutes (excluding floor drying)
- **Compatible flush-mount boxes:**
 - LEG 080031 **S**
 - LEG 080032 **D**
 - EHM 51017 **Q**



2 FINISHES



Matt white
413



Brushed steel
412



Satin nickel
418



Mirror chrome
415



Gun metal
414



Matt black
408



White enamel
424



Brushed brass
410



Satin brass
419



Mirror gold
421



Old bronze
417



Satin-finish copper
423

3 FORMATS Dimensions in mm

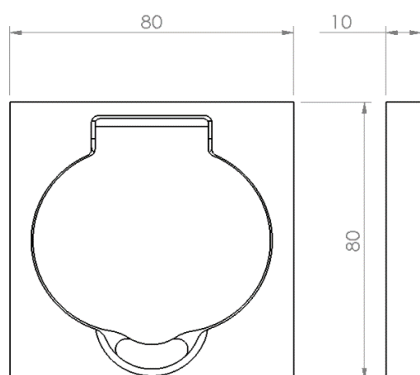

SINGLE

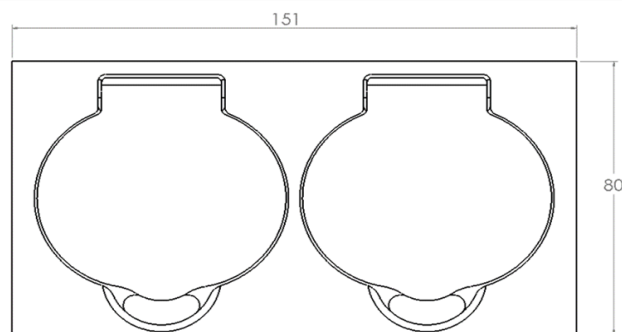

DUAL

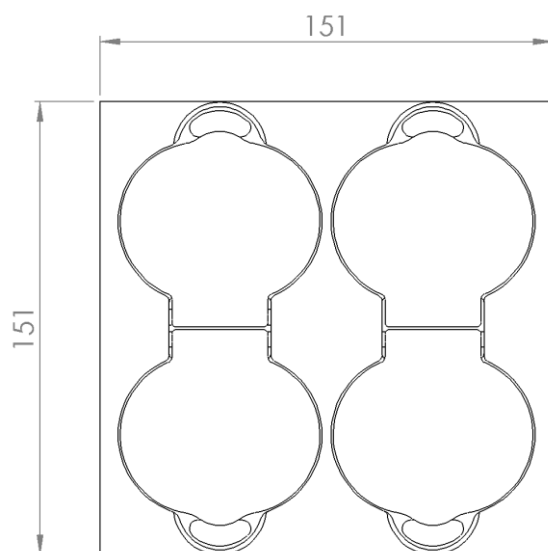

QUADRUPLE

Fixing screws under the cover

4 FUNCTIONS



R1
2P+E
Socket



K1
Schuko
Socket



M1
1 Media



U1
USB
charger

GLOSSARY

Media: RJ45 / HDMI / USB DATA / HP



5 BOX CONTENT

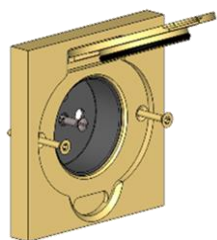

Reference SINGLE COVER PLATE:
90x-4xx

Consisting of:

- 1 Single floor socket cover plate
- 1 screw M3x20 for socket
- 2 Torx FHC screws to match cover finish

(sold separately)

Reference MECHANISM:

087-xxxGPDS

Consisting of:

- 1 Mechanism
- 1 Gasket
- 1 Installation template
- 1 Batibox O 800 32 flush-mount box with screws

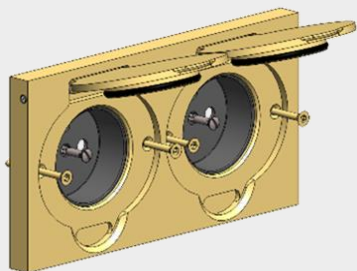
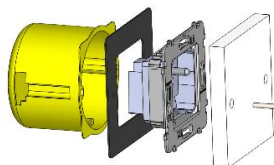

Reference DUAL COVER PLATE:
91x-4xx

Consisting of:

- 1 Dual floor socket cover plate
- 2 screws M3x20 for socket
- 4 Torx FHC screws to match cover finish

(sold separately)

Reference MECHANISM:

087-xxxGPDS

Consisting of:

- 2 Mechanisms
- 1 Gasket
- 1 Installation template
- 1 SIB P32972 flush-mount box with screws

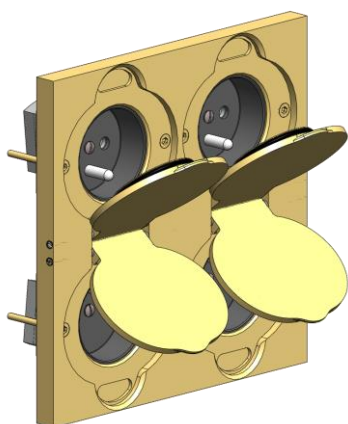
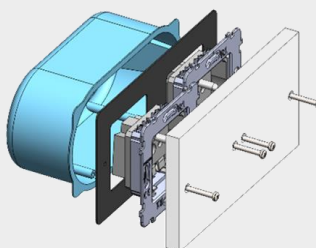

Référence QUADRUPLE COVER PLATE : 92x-4xx

Consisting of :

- 1 quadruple floor socket cover plate
- 4 screws M3x20 for socket
- 8 Torx FHC screws to match cover finish

(sold separately)

Reference MECHANISM:

087-xxxGPDS

Consisting of:

- 4 Mechanisms
- 1 Gasket
- 1 Installation template
- 1 EurHom 51017 flush-mount box with screws

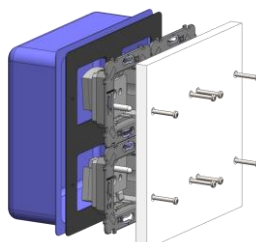

6 INSTALLATION

Switch off the mains before commencing any work.

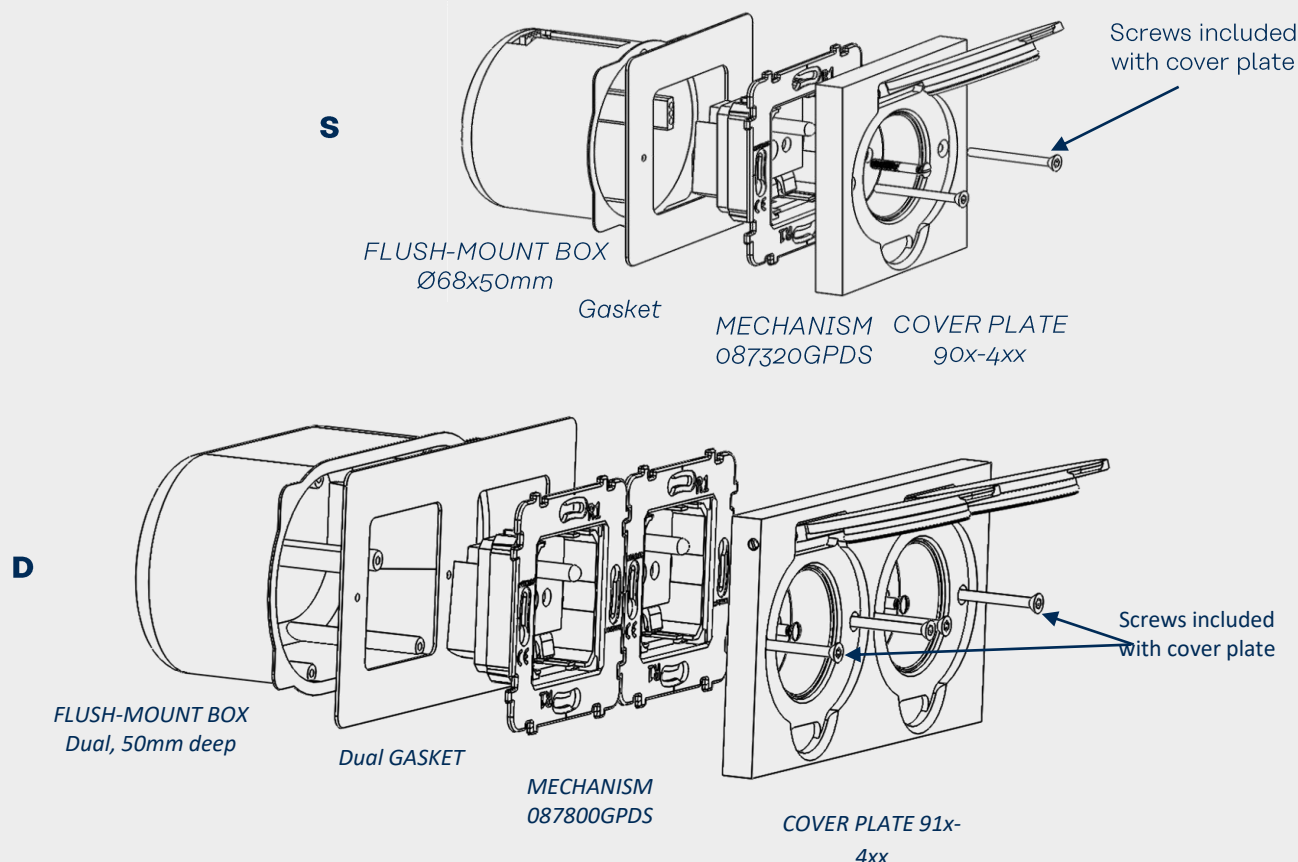

Assembly instructions:

BEFORE LAYING THE FLOOR

- Place the flush-mount box in the floor.
- Put the gasket and then the mechanism(s) in the box. Ensure vertical position is correct. Screw the installation template into the mechanism(s).

AFTER LAYING THE FLOOR

- Remove the template and wire the mechanism(s) according to the corresponding diagram(s).
- After wiring, install the floor socket cover plate.
- Lock the cover plate with the 2/4 Torx screws provided. If there is a 2P+E socket, make sure the central screw is screwed into the mechanism.

7 CARE

Clean the surface of the floor socket (plate closed) with a slightly damp cloth. **Do not use detergents.**

