

Gives direct control of the motor. Levers "always on", with foolproof system.

## 1 INSTRUCTIONS AND RECOMMENDATIONS



Switch off the mains before commencing any work



Strip the wires back for about 12mm  
Cable cross-section 0.5 min / 2.5mm<sup>2</sup> max



Mechanisms fitted with terminals with automatic connections



For single units, use casings 50mm deep, diameter 67 or 68mm

## 2 WIRING



Installation by a person with the appropriate skills.

**N** neutral – blue cable

**L** phase – red cable

 earth – green/yellow cable

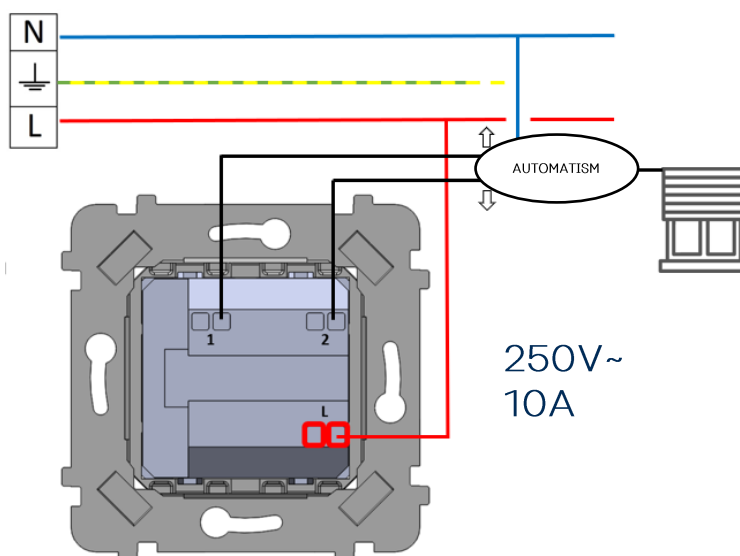

### 3 FITTING

After wiring according to the instructions, place the mechanism in the flush-mount box and screw on the plate according to the diagram opposite.

Screws supplied with the flush-mount box.

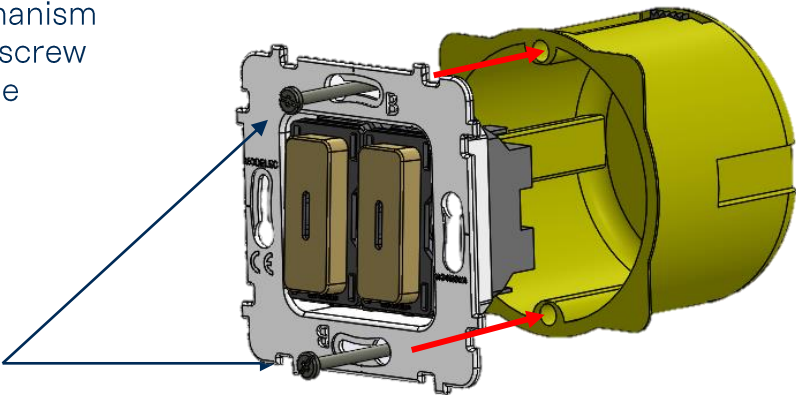

### 4 TABLE OF RELEVANT REFERENCES

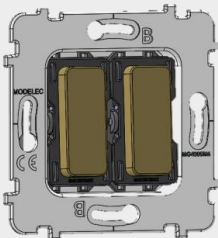

<u>Reference and description:</u>	<u>Compatible with:</u>
087-180Gxxx S SHUTTER TOGGLE	- M - Collection
087-280Gxxx S SHUTTER PUSH-BUTTON	

## 4 TABLE OF RELEVANT REFERENCES

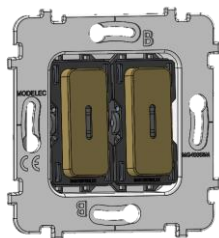

087-180Gxxx-L S SHUTTER TOGGLE  
087-280Gxxx-L S SHUTTER PUSH-BUTTON

- M - Collection

### 13 BUTTONS FINISHES

RAW

BRUSHED

SATINISED

SANDED

POLYCARBONATE



xxx =

541

542

543

512

511

514

517

532

531

IV

NO

GR

BL

## 5 CERTIFICATIONS

087 roller shutter mechanisms comply with IEC 60669-1:2017 EN 60669-1:2018.

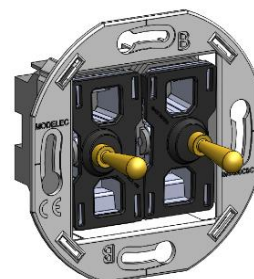
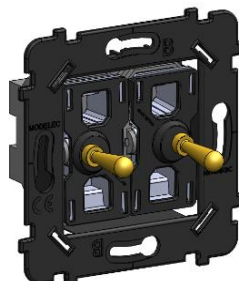
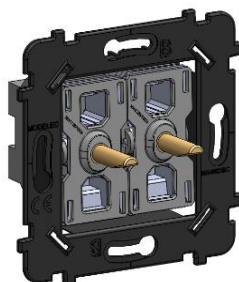
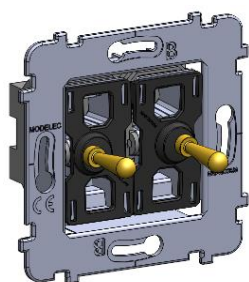

Gives direct control of the motor. Levers "always on", with foolproof system.

## 1 INSTRUCTIONS AND RECOMMENDATIONS



Switch off the mains before commencing any work



Strip the wires back for about 12mm  
Cable cross-section 0.5 min / 2.5mm<sup>2</sup> max



Mechanisms fitted with terminals with automatic connections



For single units, use casings 50mm deep,  
diameter 67 or 68mm

## 2 WIRING



Installation by a person with the appropriate skills.

**N** neutral – blue cable

**L** phase – red cable

 earth – green/yellow cable

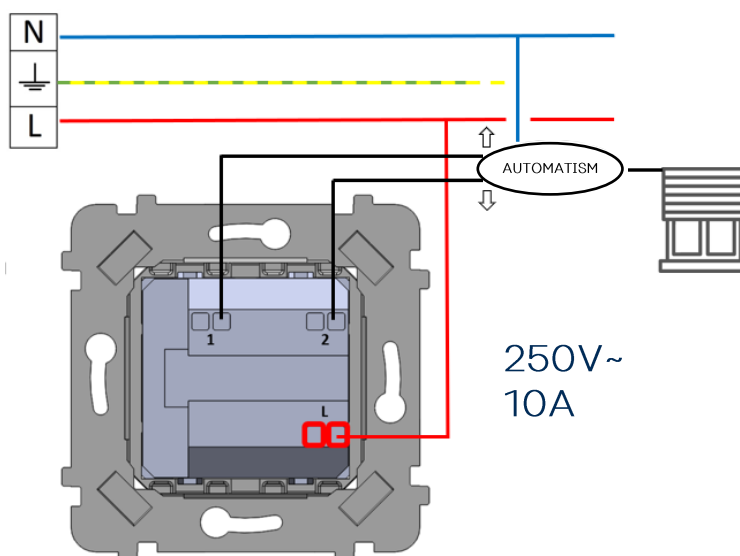

### 3 FITTING

After wiring according to the instructions, place the mechanism in the flush-mount box and screw on the plate according to the diagram opposite.

Screws supplied with the flush-mount box.

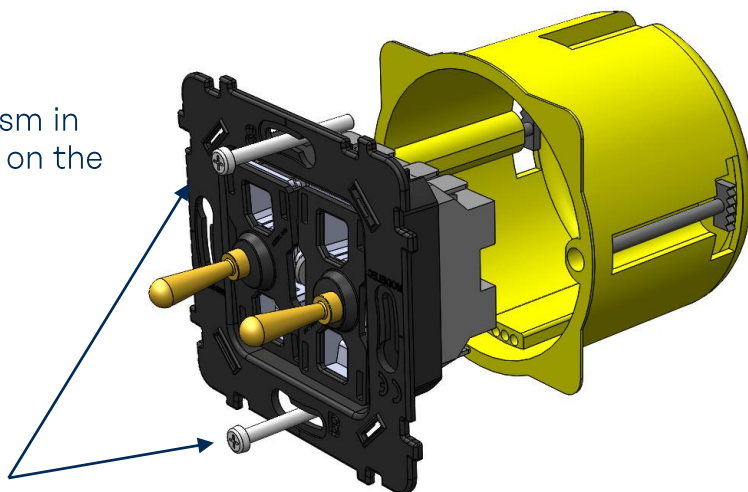

### 4 TABLE OF RELEVANT REFERENCES



xx = GOLD



STEEL



BLACK

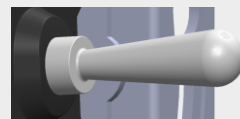

WHITE

#### Reference and description:

#### Compatible with:

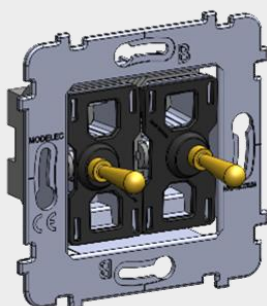

087-180Gxx S SHUTTER TOGGLE

087-280Gxx S SHUTTER PUSH-BUTTON

Confidence Collection  
Fascination Collection

## 4 TABLE OF RELEVANT REFERENCES

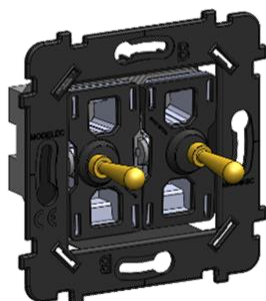

087-180Bxx S SHUTTER TOGGLE

087-280Bxx S TOGGLE PUSH-BUTTON

Désir Collection  
Karo Collection

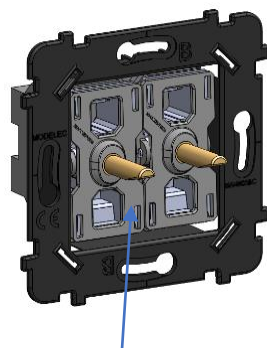

087-180BxxN S SHUTTER TOGGLE HI SBLACK

087-180BxxB S SHUTTER TOGGLE HI SWHITE

087-280BxxN S PUSH-BUTTON HI SBLACK

087-280BxxB S PUSH-BUTTON HI SWHITE

Hitera Collection

Black support (N) for 482/486/491/492 finishes

White support (B) for 481/485 finishes

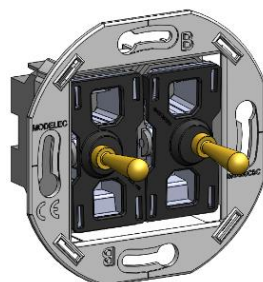

087-180Wxx S SHUTTER TOGGLE

087-280Wxx S SHUTTER PUSH-BUTTON

Iris Collection

## 5 CERTIFICATIONS

087 roller shutter mechanisms comply with IEC 60669-1:2017 EN 60669-1:2018.