

## TECHNICAL INFORMATION

# FLUSHMOUNT BOXES

## SIMPLE, DOUBLE, TRIPLE AND QUADRUPLE COVER PLATES

Our mechanisms and cover plates are mounted in standard boxes Ø67-68 mm and 50mm deep.

Example of compatible references :

### SINGLE-GANG COVER PLATE



- IMT35032 - LEG 0 800 31 - LEG 0 800 51 - BLM 680500 - LEG 0 801 51 - LEX72049012

### TWO-GANG COVER PLATE :

- - LEG0 800 32 - LEG 0 800 52 - BLM 682715 - - LEX82233614

### THREE-GANG COVER PLATE :

- - LEG0 800 33 - LEG 0 800 53 - BLM 683715 - - LEX82233614

## 3 MODULES COVER PLATES :

Our mechanisms and cover plates are mounted in 3 modules standard boxes 50mm deep.

Example of compatible references :



- LEGRAND / BTICINO : BTPB503N



- GEWISS : GW24403PM  
(shaver socket)

## NARROW AND LONG NARROW COVER PLATES :

Our mechanisms and cover plates are mounted in flush-mount boxes Ø32mm and 40 or 50mm deep.

Example of compatible references :



- LEGRAND / BATIBOX : 0 800 40  
(40mm deep)



- ARD 432002  
(50mm deep)

### IMPORTANT

*Confidence Collection with screws*

For single flush-mount boxes, place the fixing clamps horizontally, and the posts holding the cover plate fixing screws vertically.

Double, triple and quadruple boxes :  
Spacing 71 mm between each mechanism

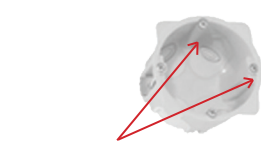

Fixing the flush-mounted box horizontally

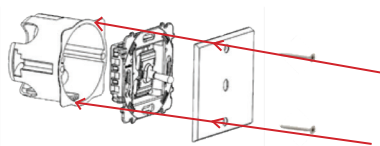

Fixing of the cover plate vertically

### IMPORTANT

*Iris by MODELEC Collection*

Cut off the lugs on the flush-mount box or choose the reference down below :

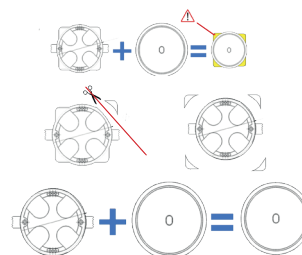

SCHNEIDER  
IMT35915

# MODELEC MECHANISMS

## 1 / REINFORCED MECHANISMS, SCREW CONNECTION.

### ■ USING

Reinforced Mechanisms are compatible and recommended for Confidence and Fascination Collections in Brass. They are suitable for use in places to intensive use and for all high-end projects.

### ■ ADVANTAGES

- Ultra resistant mechanisms
- Compliant with the installation standard without connection to the earth
- Allow very wide composition possibilities
- Additional functions available
- Addition of LED possible
- Three toggle and PUSH button finishes are available



Steel



Black



Gilt

### ■ FUNCTIONS

- Toggle, single or double: Two-way, Push-toggle
- 1 roller shutter toggle 3 positions ON/OFF/ON
- 1 roller shutter toggle 3 positions MOM/OFF/MOM (Push-toggle)
- PUSH round button
- Reading and SPOT lights
- Door bells
- LED lights (available in 220V, 12-48V and 5-12V)

### ■ RENDERING



Toggle



PUSH-round  
button



### ■ EXAMPLE

Installation until 9 toggles or PUSH round buttons on a double vertical cover plate.

# MODELEC MECHANISMS

## 2 / STANDARD MECHANISMS, AUTOMATIC CONNECTION.

### ■ USING

Standard mechanisms are suitable for housing using

### ■ ADVANTAGES

- Compatible with all our Collections
- Quiet mechanisms
- Quick and easy installation thanks to the automatic connection
- Compliant with the installation standard without connection to the earth (except socket 2P+E)
- Five flanged toggles finishes are available



White



Steel



Black



Matt brass



Shiny brass

For the Désir collection, a new straight toggle is available in the same finishes. (See p.198)

### ■ FUNCTIONS

- DUO mechanism, single or double: new function for toggle mechanisms that allows, with a same reference, to switch from a Two-way to a Push-toggle with a simple pressure (technical datasheet available on our website)
- 2 roller shutter Two-way toggles
- 2 roller shutter Push-toggles
- Sockets: 2P+E, Schuko, media (HDMI, TV, USB, RJ45, etc.)
- Other: Shutters, motion detector, card reader, cable outlet, dimmer, Bluetooth dimmer, Bluetooth shutter, low level lighting, thermostat...

### ■ RENDERING

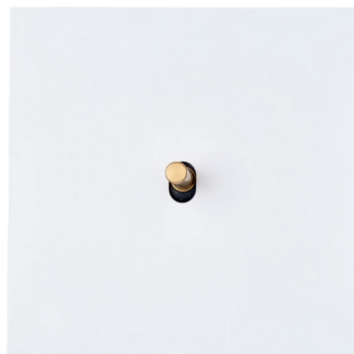

### ■ EXAMPLE

Installation until 4 toggles on a double vertical cover plate.

# MODELEC MECHANISMS - DUO FUNCTION

## 1 / CONFIDENCE, HITERA, DÉsir, IRIS, KARO COLLECTIONS

The DUO's function allows the possibility to switch from a two-way function to a push-button function with a single press.

(example : screwdriver)

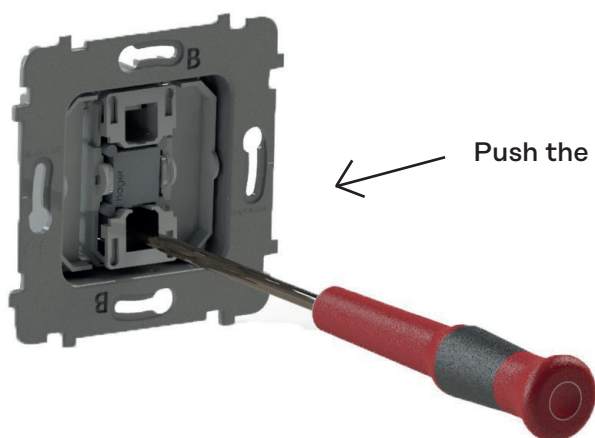

Push the black square until it «clicks»



Before any intervention, be sure to cut the power, to use compatible boxes  
(example : 50mm deep - Diameter 67 ou 68mm for single-gang cover plate).

## 2 / M COLLECTION

Note : The buttons for the -M- collection are delivered unassembled to access the «DUO» function described above, just clip them on after choosing the function.

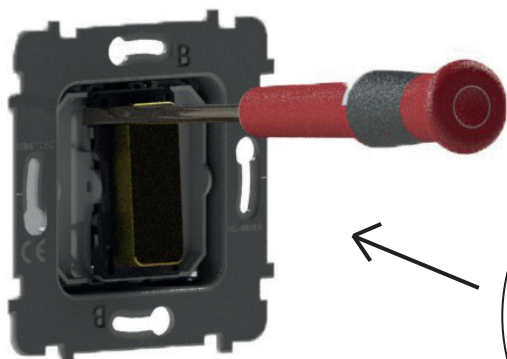

Two-way  
or Push

To change the function, remove the rocker  
and press the black square

